

IColor™ Easy Tattoo Transfer Paper

Part # ICTPTATTOO (8.27" x 11.67") (210 X 297mm)

AVAILABLE IN A4 SIZE

IColor™ Easy Tattoo Transfer Paper is an easy to use, transparent media for use on various substrates and hard surfaces such as candles, ceramic, glass, plastic, toys, luggage and of course, skin!

This product was specifically designed to work with all IColor™ transfer printers, and will also work with many popular laser or LED printers - please check with your printer manufacturer for compatibility. **The use of an IColor™ printer in white overprint mode is highly suggested.**

INSTRUCTIONS FOR BEST RESULTS:

1) **Place transfer sheet into the appropriate tray of the IColor™ printer.**

⚠ The semi matte side of this media is the print side.

- IColor™ 650 / 600 / 500 / Most OKI Printers: Print side face up in Multipurpose Tray
- IColor™ 560 / 550 / 540 / 800: Print side face down in the Bypass Tray

2) **Printer Settings:**

In the RIP software settings, choose the paper type according to the printer being used. Make sure you are working within the overprint queue in the ProRIP software or 'B' Configuration if using the TransferRIP software.

⚠ Specific print modes and sizes for this paper are available when using the IColor™ ProRIP software.

- Listed as 'UNINET IColor Easy Tattoo'
- The page size should be set to A4.

Otherwise, use the following settings based on the printer:

- IColor™ 650 / 600 / 500 / Most OKI Printers: Set media type to 'Transparency' and media weight to 'Ultra Heavy 1'
- IColor™ 550 / 540: Set paper type to 'Thick to 163g'
- IColor™ 560: Set paper type to 'Thick to 105g'
- IColor™ 800: Set paper type to 'Thick to 163g' (Thick to 220g may be needed for extra heavy coverage)

⚠ If not already done automatically in the RIP, remember to set the job to **mirror print**, ensuring the correct orientation when transferred to the substrate.

⚠ White overprint should be set to at least 200% (use default ProRIP settings when possible).

3) **If using the IColor™ TransferRIP or ProRIP Software, add 200% – 300% white overprint if applying to clear or dark surfaces.**

⚠ IColor™ 560 / 550 / 540: Do not exceed 280% white overprint

- Completely black images do not require a white overprint, and it is suggest to print in rich black (CMYK) or composite black (CMY) for best results.

4) Print the image.

5) Locate the adhesive 'B' sheet.

- Peel off a corner of the white backing paper and fold it over.



6) Place the Transfer 'A' sheet face up (printed side up) on a flat surface.

- Stick the exposed adhesive corner precisely on the corresponding corner of the 'A' sheet.

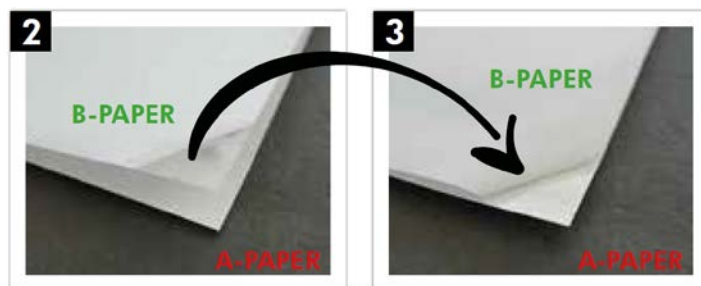

7) Use a squeegee, ruler or something similar and push the 'B' adhesive backing paper away by rubbing over it.

- The adhesive is now applied and the tattoo paper is ready for transfer.



8) Cut around the design as exact as possible. You can use a pair of scissors or most cutters/plotters.

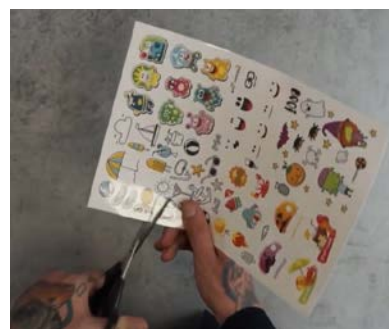

9) Peel off the glossy foil.

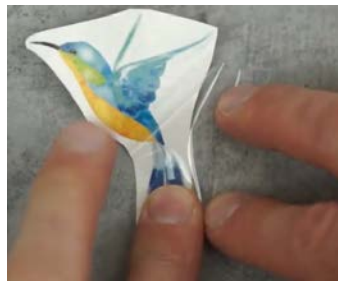

10) Position the tattoo face down on clean and dry skin.



11) Soak the Tattoo with a damp sponge until wet thoroughly.

- Apply light pressure to the tattoo.



12) After the image is sufficiently soaked with water, it is ready to be peeled off.

- It's ready when the backing paper can be moved with minimal force.



13) Affix the top of the media to the substrate where the liner was removed.

- Hold the media on the substrate at the point of contact and slowly pull the liner away in one smooth motion.

14) Align the image on the substrate as desired.

- Brush it with your finger or a piece of plastic to remove any creases or air bubbles.

15) Use a towel to remove any excess water and let dry for at least three hours.

- ⚠ May require 12 – 24 hours to dry completely.

To see video instructions for IColor™ Easy Tattoo Transfer Paper visit www.icolorprint.com/video (Coming soon)

TECH TIPS

Avoid Jams:

- **Allow your media to acclimatize** – do not use the media if just delivered, especially during periods of extreme temperatures or humidity. Allow it to come to room temperature before using.
- **Do not print too close to the edges of the media.** Leave a border of approximately ½” between your artwork and the edge of the media.
- **Be sure to use the suggested paper type and media type before printing.**
- **Always make sure you select the media size which matches the media being used** and is appropriate for your printer.
- The tattoo has a very strong adhesive. Depending on the design, size and placement of the tattoo, the durability is about 2-4 days.
- If you wish to remove your tattoo, you can simply use sticky tape / scotch tape or baby oil and rub it off.
- For a more matte looking appearance, you can rub Sun Screen carefully over your new tattoo.

Optimal Humidity Level: 45% - 65%

- Regulated with A/C, a humidifier or de-humidifier, depending on current atmospheric conditions.

Optimal Temperature Range: 50°F / 10°C - 75°F / 24°C

Use of this media outside of these recommend parameters may lead to poor results.

ALSO AVAILABLE:

- IColor™ Premium and Premium Stretch 2 Step Transfer Paper for light and dark colored garments
- IColor™ Select and Select Ultra Bright 2 Step Transfer Paper for light and dark colored garments
- IColor™ Standard 2 Step Transfer Paper for light and dark colored garments
- IColor™ Glitter Adhesive 2 Step Transfer Paper (for use with IColor™ Standard 2 Step Transfer Paper)
- IColor™ Light and Speed Trans Light 1-Step Transfer Paper for light colored garments
- IColor™ Presto 2 Step Transfer Paper for textiles and hard surfaces
- IColor™ Temporary Tattoo 2 Step and Easy Tattoo Transfer Paper
- IColor™ Classic, Premium, Wood and Leather and Ceramic Hard Surface 1-Step Transfer Paper
- IColor™ AquaClear 1-Step Transfer Paper for candles and other substrates not resistant to heat
- IColor™ Label / Sticker Paper (Clear and White) in Letter and Tabloid size
- IColor™ Window Cling Media (Clear and White) in Banner and cut sheet options
- IColor™ Banner Paper
- IColor™ Magnetic Media in Letter and Tabloid size

...and more! Contact your dealer for more information.

IColor™ Transfer Paper Comparison Charts

ICOLOR TEXTILE TRANSFER PAPER

ATTRIBUTE	PREMIUM	PREMIUM STRETCH	STANDARD	SELECT UB	SELECT	PRESTO	LIGHT	SPEEDTRANS LIGHT
PROCESS	2 Step	2 Step	2 Step	2 Step	2 Step	2 Step	1 Step	1 Step
DURABILITY (# of Washes @ 104 °F/40 °C)	Up to 100	Up to 100	50+	50+	50+	50+	15+	15+
DARK TEXTILES (BRILLANCE)	BEST	BEST	BETTER	BEST	GOOD	BETTER	FAIR	FAIR
DELICATE TEXTILES	BEST	BEST	GOOD	GOOD	GOOD	GOOD	NOT RECOMMENDED	NOT RECOMMENDED
STRETCHABILITY	BETTER	BEST	GOOD	BEST	BEST	GOOD	GOOD	GOOD
FINISH	MATTE	MATTE	SEMI GLOSS	MATTE	MATTE	SEMI GLOSS	SATIN	SATIN
TRANSFER 'A' SHEET CHARACTERISTIC	OPAQUE	OPAQUE	TRANSPARENT	TRANSPARENT **	TRANSPARENT	OPAQUE	OPAQUE	OPAQUE
PRESS TEMPERATURE (°F/°C)	250°F / 120°C	285°F / 140°C	310°F / 154°C	310°F / 154°C	310°F / 154°C	285°F / 140°C	390°F / 200°C	375°F / 190°C
PRESS TIME	30 + 30 secs	45 + 10 secs	120 + 30 secs	120 + 25 secs	120 + 25 secs	120 + 30 secs	15 secs	10 secs
SOFT HAND	BEST	BEST	GOOD	GOOD	GOOD	GOOD	BETTER	BETTER
COST	\$\$\$	\$\$\$	\$\$	\$\$	\$\$	\$\$	\$	\$

** Select 800 Ultra Bright has an opaque 'A' sheet

ICOLOR HARD SURFACE TRANSFER PAPER

ATTRIBUTE	PREMIUM	CLASSIC	CERAMICS	WOOD/LEATHER	PRESTO! HARD SURFACE	PRESTO! PAPER/WOOD	AQUACLEAR	TATTOO
PROCESS	1 Step	1 Step	1 Step	1 Step	1 Step	1 Step	1 Step	2 Step
DURABILITY (RESISTANT TO SCRATCHING/CHIPPING)	BEST	BEST	BEST	BEST	BEST	BEST	GOOD	BETTER
COLOR BRILLIANCE	BETTER	BETTER	BETTER	BETTER	BEST	BEST	BETTER	BETTER
METALLIC FINISH	NO	NO	NO	NO	YES	YES	NO	NO
PRESS TEMPERATURE (°F/°C)	300°F / 150°C *	300°F / 150°C *	300°F / 150°C *	300°F / 150°C *	320°F / 160°C *	265°F / 130°C *	N/A	265°F / 130°C
PRESS TIME	60 SECS *	60 SECS *	180 SECS *	60 SECS *	180 SECS *	90 SECS *	N/A	40 SECS
ACRYLIC	YES	YES	YES	YES	YES	NO	YES	YES
METAL	YES	YES	NO	NO	YES	NO	YES	YES
CERAMIC	YES	YES	YES	NO	YES	NO	YES	YES
TILE	YES	YES	YES	NO	YES	NO	YES	YES
GLASS	YES	YES	YES	YES	YES	NO	YES	YES
CRYSTAL	YES	YES	YES	YES	YES	NO	YES	YES
PAPER/WOOD/CARDBOARD	YES	YES	NO	YES	YES	YES	NO	YES
LEATHER	YES	YES	NO	YES	NO	NO	NO	YES
CANDLES	NO	NO	NO	NO	NO	NO	YES	YES
FLESH	NO	NO	NO	NO	NO	NO	NO	YES
COST	\$	\$	\$	\$	\$\$	\$\$	\$\$	\$\$\$

* Temperature and press time varies based on substrate

March 2022 Revision - A newer version of this manual may be available at www.icolorprint.com/support

(Or scan this QR Code)

